

PortSIP Softphone

STEP-1: DOWNLOAD THE APP THROUGH THIS LINK-

<https://play.google.com/store/apps/details?id=com.portgo>

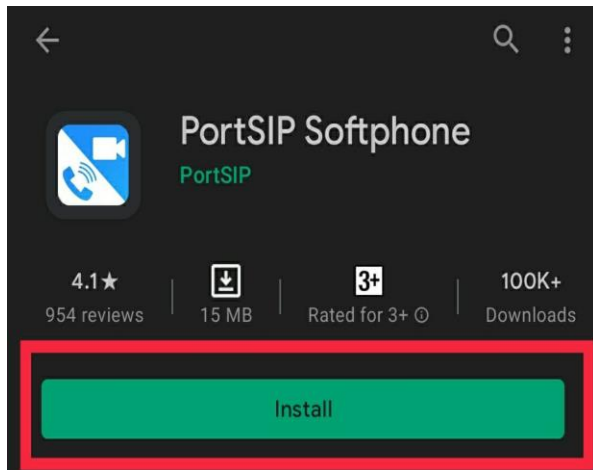

STEP-3: INPUT VALID INFORMATIONS

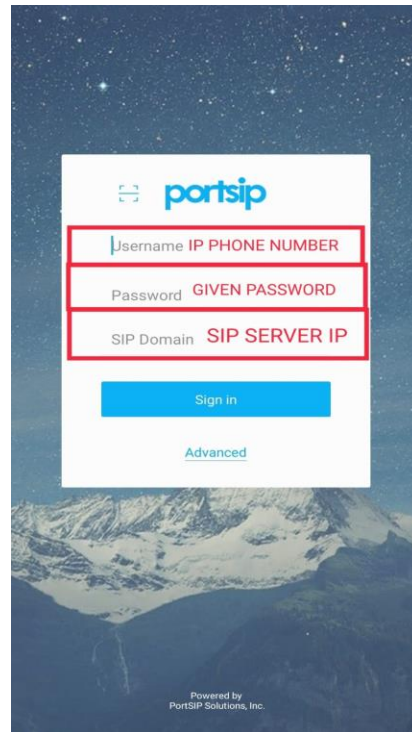

STEP-2: GO TO SETTING

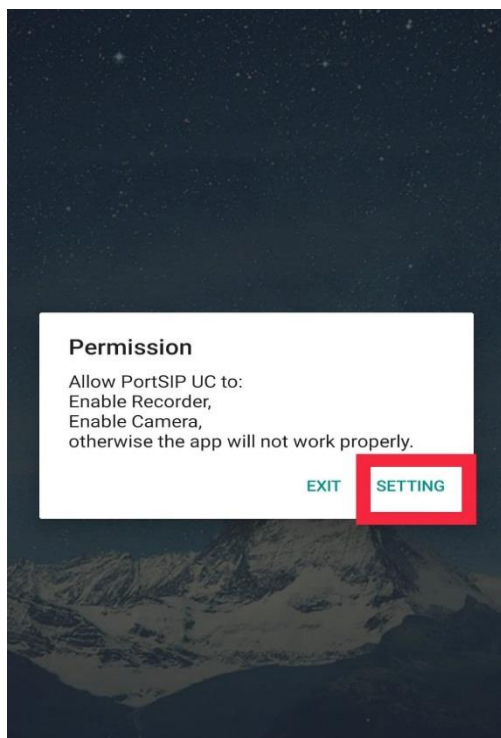

STEP-4: ACCOUNT IS READY FOR USING

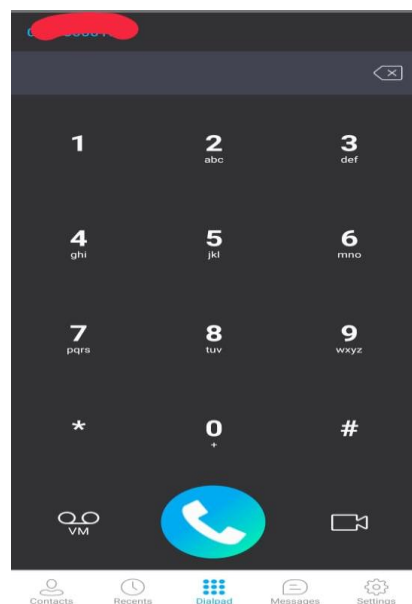

PortSIP Softphone

*** IF ALREADY ONE ACCOUNT IS REGISTERED,
DELETE IT TO ADD YOUR PCL ACCOUNT ***

***IF FACING REGISTRATION PROBLEMS,
REMOVE AND ADD PCL ACCOUNT AGAIN***

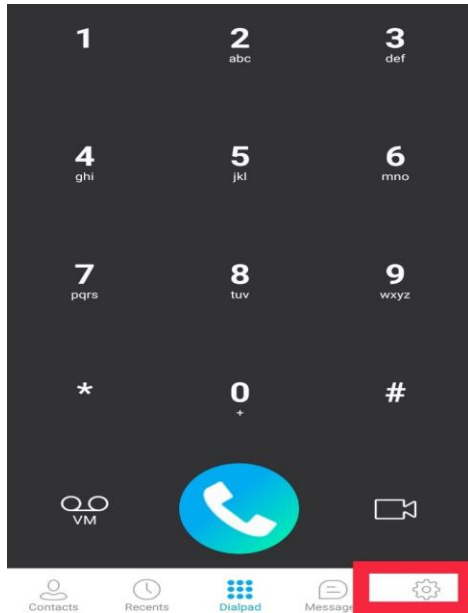

NEXT

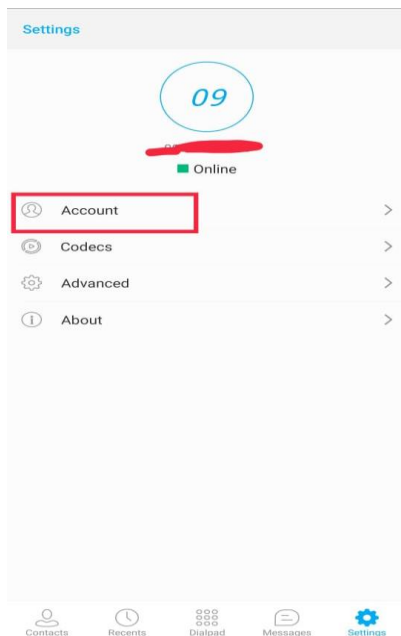

NEXT

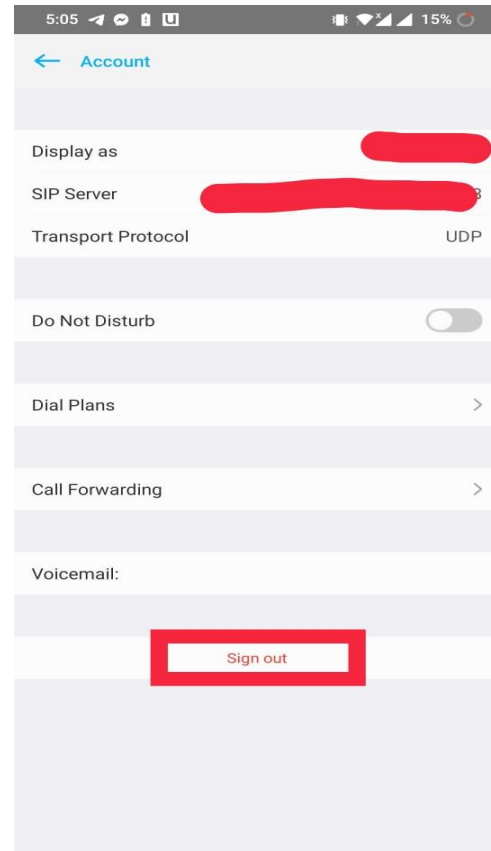

*** LONG PRESS ON REGISTERED ACCOUNT AND
REMOVE IT ***

*** IN FREE VERSIONS, APPS DID NOT ALLOW
TWO ACCOUNTS IN PARALLEL ***